

Location of Wastewater Connection



Public Works Maintenance
1820 Roosevelt Blvd.
Eugene, Oregon 97402
(541) 682-4800

Property Information

Address 2248 Willona Dr

Map and Tax Lot _____ Owner _____

Building Type: SFD Duplex Multi-Family Commercial Industrial

Permit Information

Permit No. _____ Date of Issue _____

Contractor/Plumber: JT'S EXC. Pipe Material SC44 40⁽¹²⁾ Pipe Diameter 4

Right of Way Cut/Permit Required

System Development Charge

Installation Date 5/10/2023 Inspected By TSH

Permission granted to attach private sewer connection to public sewer in conformance to City standards and specifications.

Public Wastewater Information

Inspected By _____

Index Page No. _____ Segment No. _____ Upstream _____ Downstream _____ Contract No. _____

TWO WORKING DAYS BEFORE YOU DIG, CALL UTILITY ONE-CALL SERVICE AT 1-800-332-2344

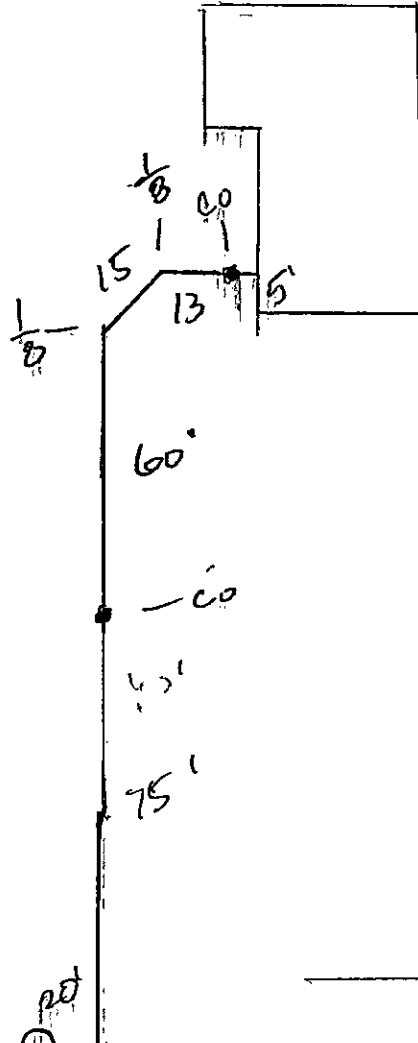

Willona Dr

7397

7398

7399